



AMERICAN SPECIALTIES, INC.

441 Saw Mill River Road, Yonkers, NY 10701 (914) 476-9000

MODEL No: 170

ISSUED: 1-87

REVISED: 9-96

RETRACTABLE SHOWER SEAT - FRONT MOUNTED

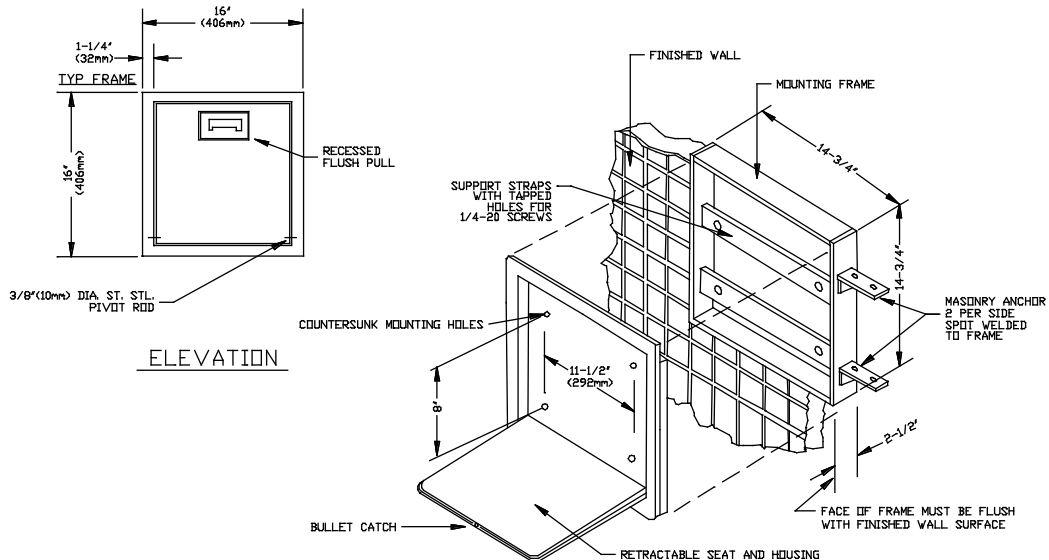

SPECIFICATION

Retractable Shower Seat for recessed front mounting shall be fabricated of alloy 18-8 stainless steel, type 304, № 16 gauge with № 4 satin finish. Seat shall be double pan construction with welded perimeter seam and internal edges shall be reinforced with flat stock. Seat shall have flush recessed stainless steel pull handle accessible when unit is closed and shall pivot on 3/8" (10mm) diameter solid stainless steel rod. Seat housing shall be fabricated of 1/8" (3mm) thick same grade and finish stainless steel with face trim miters welded and ground smooth. Mounting frame shall be fabricated of 3/16" (5mm) thick cadmium plated steel with support straps welded on and shall have tapped holes to accept seat housing. Mounting frame shall have two (2) masonry anchors per side for building into concrete or block wall. Retractable shower seat shall be capable of sustaining a weight of 550 pounds when anchored to suitable frame.

Retractable Shower Seat - Front Mounted (recessed) shall be Model № 170 as fabricated by American Specialties, Inc., 441 Saw Mill River Road, Yonkers, New York 10701-4913

CAUTION

Shower seat is no stronger than anchors or wall to which they are attached. Shower seat must be firmly and securely attached to sustain loads which it is intended to support.

INSTALLATION

Install outside edge of mounting frame flush with finished wall surface. Use suitable fasteners (by others) through holes provided in masonry anchors to attach frame to wall structure. Ensure that installation meets all applicable codes. Install and secure retractable seat into mounting frame with four (4) 1/4"- 20 x 2" long Torx® flat head machine screws (supplied) through countersunk mounting holes provided. Seal seams, joints and screw holes with sealant, caulk or grout as appropriate (by others). For compliance with ADA Accessibility Guidelines install unit seat surface in down position 17" (482mm) minimum above finished floor (AFF) to 19" (482mm) maximum AFF.

Rough wall Opening (RWO) required is 15" W x 15" H x 2-3/4" D (381mm x 381mm x 70mm).

OPERATION

Use the recessed flush pull to disengage the seat and lower it to the horizontal sitting position. When not in use, return the seat to the vertical storage position.

Accessory Specialties

AMERICAN DISPENSER

Desert Ray Products

WATROUS INC.